

The selection of glazing in doors should be based on considerations of observation and of safety, e.g. the need to avoid collision between users approaching the door from opposite sides, bearing in mind that users may be adults or children, ambulant or in wheelchairs, and may be carrying objects or pushing or pulling mobile equipment.

A lower panel of glazing will considerably increase visibility which may be desirable in busy areas or where children are present.

Unless otherwise specified in contract documents, Shadbolt will offer doors to the following specifications:

- Heavy duty grades - Nom. 6mm toughened or laminated safety glass .
- FD30 fire-resisting grades - Pyrobelite 7 glass (Nom. 7.9mm) - BS6262 Class C.
- FD60 fire resisting grades - Pyrobel 16 glass (Nom. 17.3mm) - BS6262 Class 'B'

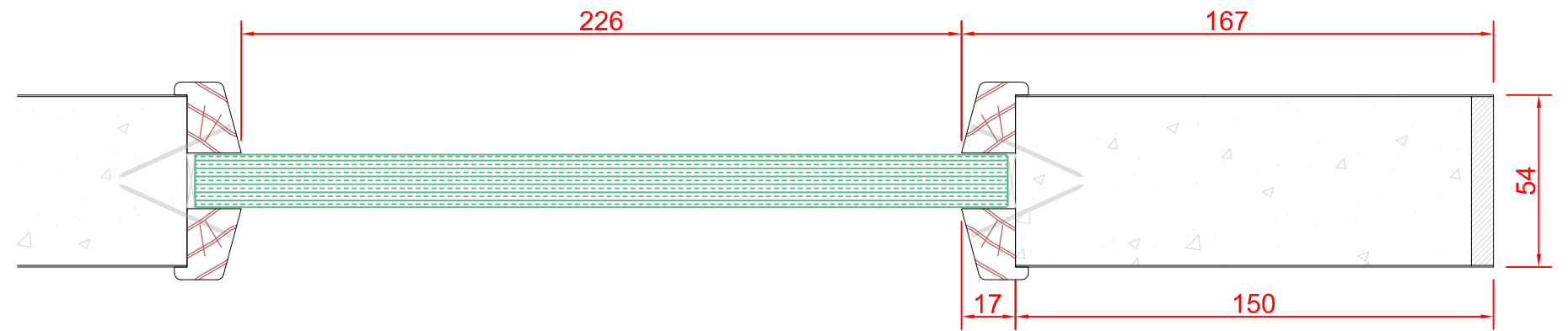
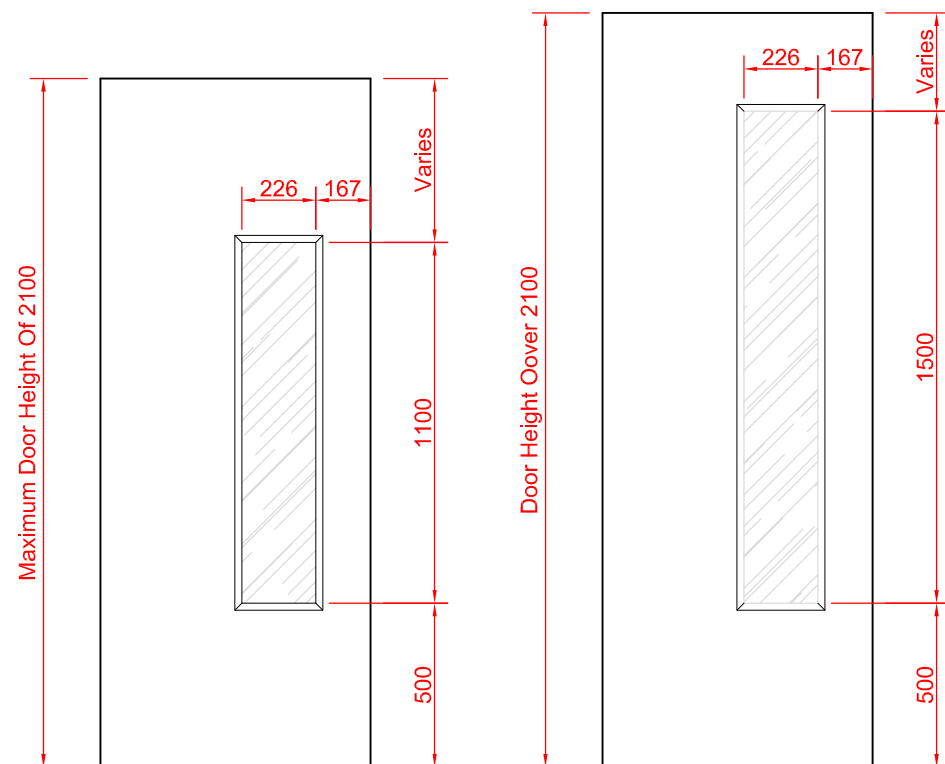
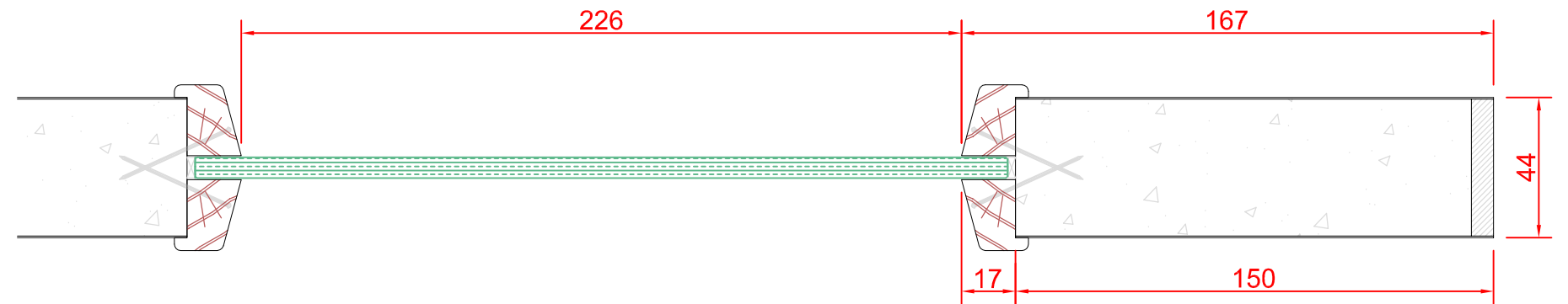
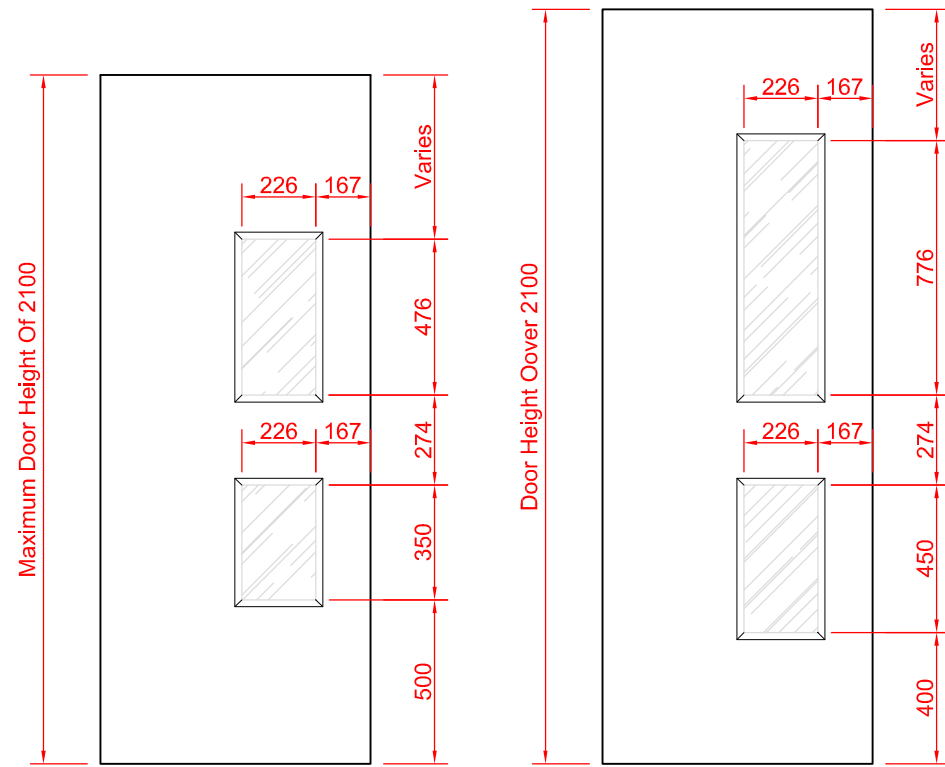

ALL DIMENSIONS ARE TO GLASS SIGHT LINES

Shadbolt
International

F.R.Shadbolt & Sons Ltd.
Springwood Drive,
Braintree
Essex CM7 2YN

+44 (0) 1376 333376
+44 (0) 1376 333377
sales@shadbolt.co.uk
www.shadbolt.co.uk

FRS Standard Vision Panel Details
Queries Sheet – Query 10.11

SPEC-329